

# V1816WF

Model : V1816W			
Sensing Area(°)	1/4"		
Field of View(°) D/H/V±1%	163.3	120.86	89.5
TV Distortion(%)	-22.64		
Focal Length	1.81 mm±5%		
Back Focal Length	3.39 mm±5%		
Flange Back Length	3.13 mm±0.3		
F/#	2.4		
Iris	Fixed		
Diameter (Thread)	M12.0 × 0.5 Pitch		
TTL	16.77 mm±0.4		
Lens Construction	6 Elements (1 Aspheric) & Color Compensation Filter		

## Features

- High Image Quality
- Compatible with CCD, OV7950, Micron Image Sensor
- Getting a bright visual image with this lens
- Automotive, Security and Surveillance Applications



## Dimension

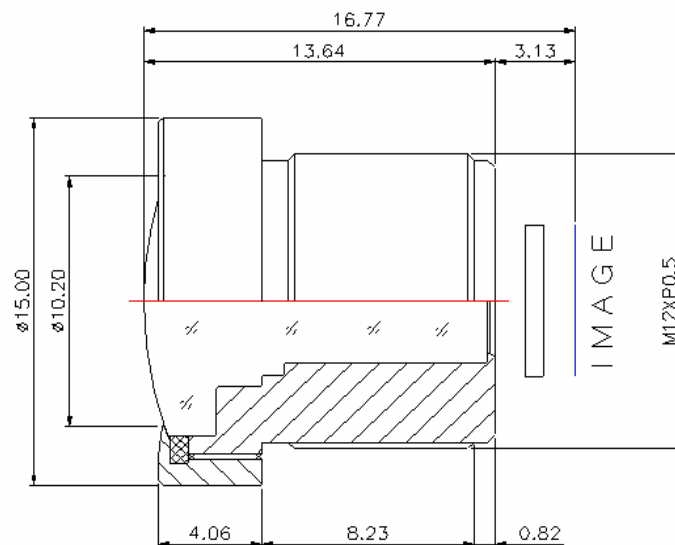

Subject to change without notice